

STATE UNIVERSITY OF NEW YORK
UNIVERSITY AT ALBANY

2016 CAMPUS STATEMENT

The University at Albany, established in 1844, was the first state-chartered institution of higher education in the State of New York. A premier academic institution and one of four university centers in the SUNY system, Albany offers over 120 graduate programs and over 50 undergraduate majors in a broad range of academic fields at the baccalaureate, master's, and doctoral degree levels and is classified by Carnegie as a research university with very high research activity.

Several University at Albany academic programs are nationally ranked, including Criminal Justice, Information Sciences, Educational Administration, Social Welfare, Public Administration and Policy, Clinical Psychology, and Sociology. The University hosts more than 50 institutes and centers, including the prestigious New York State Writers Institute, the RNA Institute, the Atmospheric Sciences Research Center, and four federally funded research centers.

The University's broad mission of excellence in undergraduate and graduate education, research, and public service engages approximately 18,000 diverse students in ten schools and colleges across three campuses: Uptown (main) Campus, Downtown Campus, and Health Sciences (East) Campus. The Uptown Campus, at approximately 400 acres and 5 million total square feet, is noted for the monolithic poured concrete 'Podium', designed by Edward Durell Stone and built in the late 1960's. This facility houses the majority of the University's academic and residential spaces and programs. The Downtown Campus is noted for its traditional "bricks and ivy" buildings, constructed in the early 1900's, housing four highly ranked professional schools. The Health Sciences Campus is the site of the School of Public Health and numerous University research laboratories and business collaborations, including the Cancer Research Center and various other traditional lab facilities. In aggregate, over 70 percent of the University's building inventory is 40 years or older, including some of the Downtown Campus buildings that are more than 100 years old, with several of those eligible for listing as historical structures.

Each of these campuses presents its own urgent renovation and infrastructure investment needs. The most challenging is the academic portion of the Uptown Campus known as the Podium. It is an entirely unique architectural "mega structure", densely constructed with over two million square feet in 14 interconnected buildings that share roofing, mechanical, plumbing, electrical, and HVAC systems – virtually all of it 50 years or older in age and considered to be at or near obsolescence. The 2012 Facilities Master Plan laid out a carefully crafted and thorough 30 year renovation strategy that divides the Podium into three "zones" allowing simultaneous renovations at each location. This critically important plan, however, hinges on both adequate swing space and sufficient capital funding. A portion of the swing space was created when the Business Building was constructed and opened in August 2013. Other swing space may become available when the renovation of the Schuyler School building on the Downtown Campus is fully funded and completed.

Design has begun on a new Emerging Technology and Entrepreneurism Complex (ETEC) building which is the capital component of the University's NY2020 plan. The new facility will co-locate academic instruction and research, business partners, technology transfer, and business development programs. The building will also be the home of the new College of Homeland Security and Emergency Preparedness, announced by the Governor in the 2015 State of the State Address. The ETEC project is currently scheduled for completion in 2020-21.

The University continues to advance completion on projects funded from remaining prior year capital plan appropriations that focus on addressing a wide array of deferred maintenance needs. These include upgrades of key systems in the Uptown boiler and chiller plant; ongoing, multi-year roof replacement projects; gut-renovation of the former Health Center (Building 25); gut renovation of the former Business Administration Building (Building 27); a series of projects to address water infiltration and concrete canopy and deck repair on the Podium; multi-phased elevator replacement projects; replacement and upgrades to underground utilities, including restoration of landscaping; replacement and upgrade of downtown fire alarms; restoration and upgrade of downtown building cornice and façades; and priority replacement and upgrades of aging and inefficient instructional spaces, including the Lecture Center complex and various instructional science labs. The campus continues to program and design additional projects in the anticipation of additional capital funding being awarded to the campus.

**State University of New York
University at Albany**

Facility Profile

Facility Profile	Instructional & Support	Residential	Total
Total State Owned Acreage			517.67
Total State Owned Buildings	49	99	148
Total State Owned Gross Square Feet (GSF)	3,269,526	2,349,274	5,618,800
Total State Owned Net Assignable Square Feet (NASF)	2,028,308	1,160,613	3,188,921

Age of Facilities	< 10 Years	10 – 40 Years	> 40 Years
Gross Square Feet	417,228	1,238,027	3,963,545
Percentage of Total GSF	7.4%	22.0%	70.5%



Net Assignable Space Distribution by Major Functional Area						
Instructional	Research	Student Activities	Administration	Central Services	Residential	Total
23%	9%	11%	4%	10%	43%	100%



Downtown - Campus Owned Facilities

BUILDING INDEX

- 1 DRAPER HALL
- 2 HAWLEY HALL
- 3 HUSTED HALL
- 4 RICHARDSON HALL
- 5 PAGE HALL
- 6 MILNE HALL
- 9 PIERCE HALL
- 10 SAYLES HALL
- 11 BRUBACHER HALL
- 12 ALDEN HALL
- 13 WATERBURY HALL
- 523 PHILIP SCHUYLER SCHOOL

-  ACADEMIC BUILDINGS
-  RESIDENTIAL BUILDINGS

FALL 2015

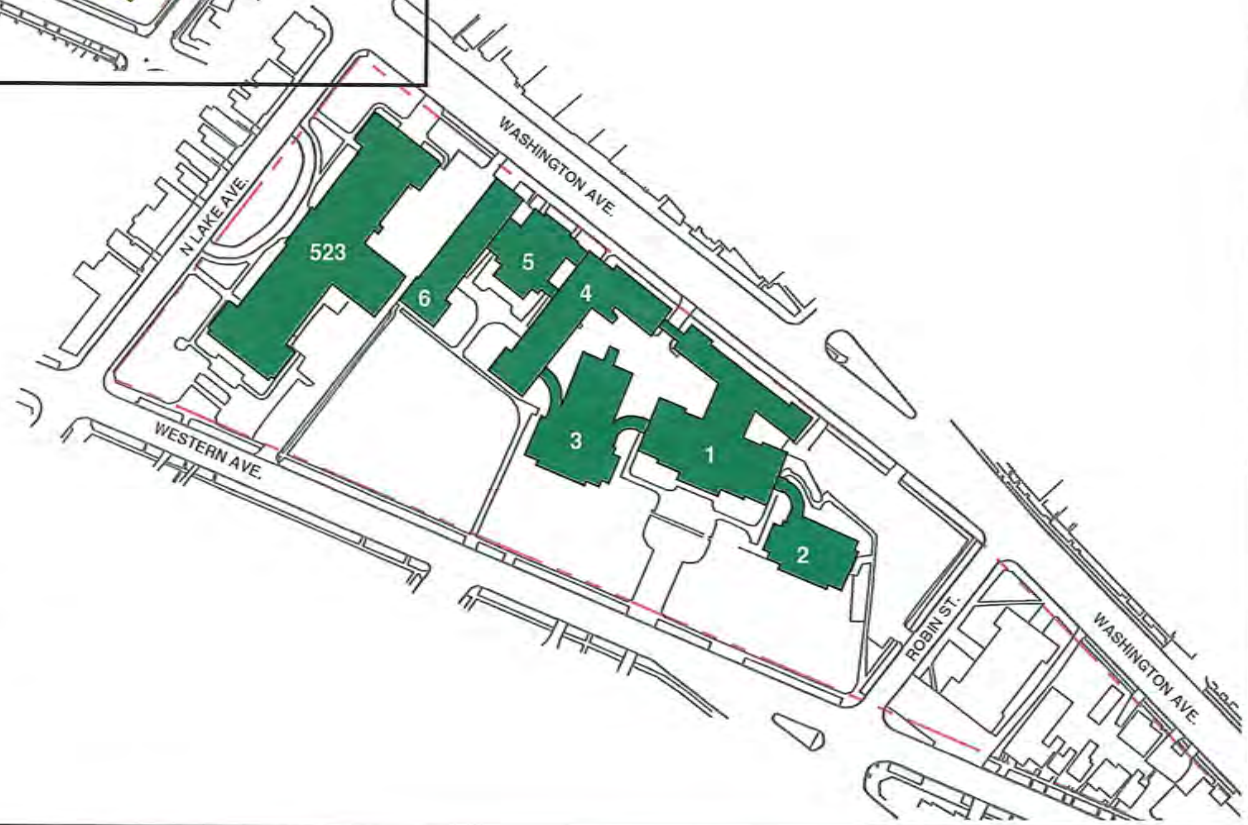
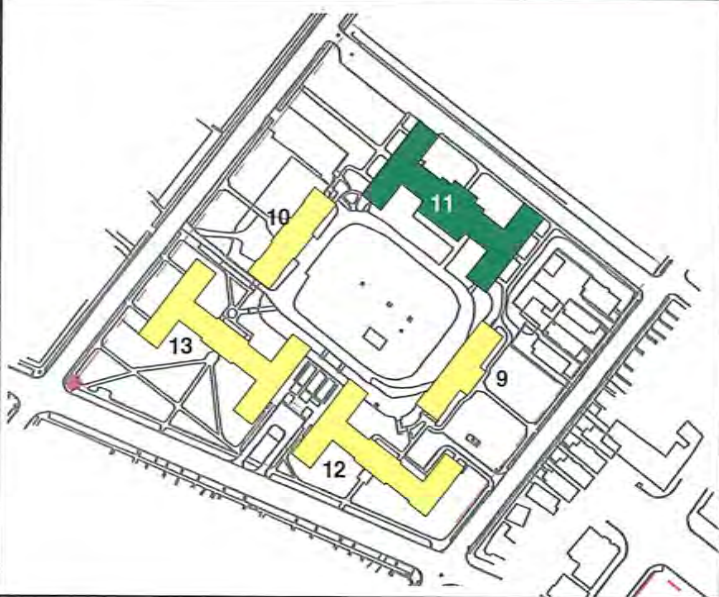

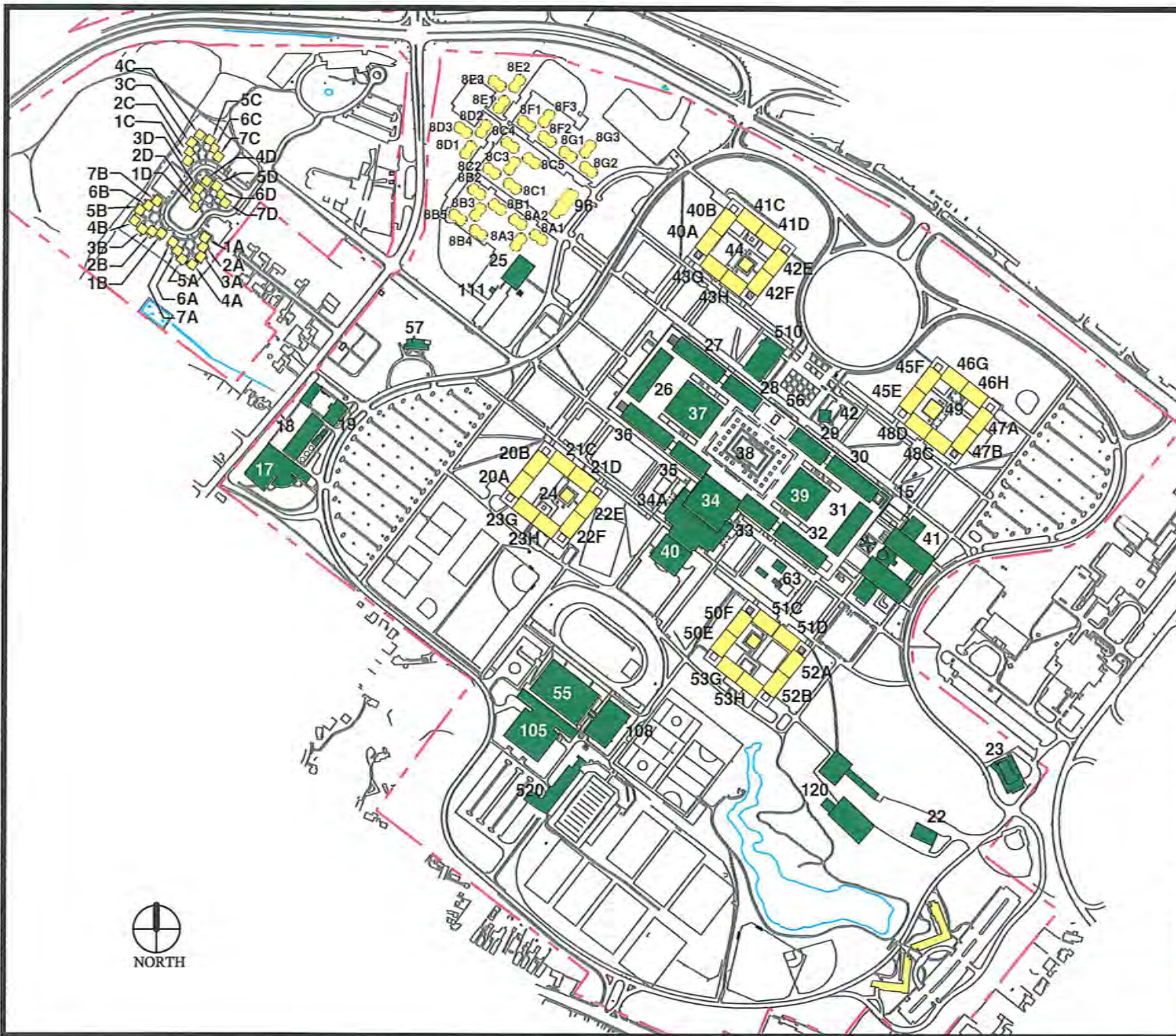

BUILDING INDEX		
8	PUMP HOUSE	50E ONEIDA XIII
15	LINEAR ACCELERATOR LAB	50F ONONDAGA XIII
17	INFORMATION TECHNOLOGY	51C MAHICAN XIII
18	POWER PLANT	51D MONTAUK XIII
19	SERVICO BLDG	52 ALBIONACK XIII
20A	VAN RENSSELAER VII	52B CAYUGA XIII
20B	RYKMAN VII	53G SENECA XIII
21C	TEN EYCK VII	53H TUSCARORA XIII
21D	TEN BROECK VII	54 MOHAWK TOWER STG XIII
22	UNIV. POLICE DEPT.	55 PHYSICAL EDUCATION
22E	BLEECKER VII	56 COMPUTING CENTER
22F	VAN CORTLAND VII	57 ALUMI HOUSE
23	BOOR SCULPTURE STUDIO	60 PARKING BOOTH
23G	BEVERWYCK VII	61 PARKING BOOTH
23H	SCHUYLER VII	62 HAZARDOUS CHEM. STORAGE
24	STUYVESANT TOWER	63 PARKING AND MASS TRANSIT
25	HEALTH & COUNSELING SRVCS	95 LIBERTY PLACE (12)
26	SOCIAL SCIENCE	102 WHITEFACE WEATHER STATION (not shown)
27	BUSINESS	105 RECREATION & CONVOCAION
28	ARTS AND SCIENCES	108 AIR STRUCTURE
29	FINE ARTS	111 AMBULANCE GARAGE
30	EARTH SCIENCE	120 GROUNDS BUILDING
31	BIOLOGY	510 BUSINESS BUILDING
32	CHEMISTRY	520 MULTI-PURPOSE STADIUM
33	PHYSICS	1A TRUTH - 1
34	CAMPUS CENTER	2A TRUTH - 2
34A	CAMPUS CENTER EXTENSION	3A TRUTH - 3
35	EDUCATION	4A TRUTH - 4
36	HUMANITIES	5A TRUTH - 5
37	LIBRARY	6A TRUTH - 6
38	LECTURE CENTER	7A TRUTH - 7
39	PERFORMING ARTS CENTER	1B STANTON - 1
40	NEW LIBRARY BUILDING	2B STANTON - 2
40A	CLINTON VIII	3B STANTON - 3
40B	DELANCY VIII	4B STANTON - 4
41	LIFE SCIENCE BUILDING	5B STANTON - 5
41C	HAMILTON VIII	6B STANTON - 6
41D	HERKIMER VIII	7B STANTON - 7
42	UNIVERSITY HALL	1C NORTHHRUP - 1
42E	JOHNSON VIII	2C NORTHHRUP - 2
42F	MORRIS VIII	3C NORTHHRUP - 3
43G	PAINE VIII	4C NORTHHRUP - 4
43H	ZENGER VIII	5C NORTHHRUP - 5
44	LIVINGSTON TOWER	6C NORTHHRUP - 6
45E	MELVILLE X	7C NORTHHRUP - 7
45F	STEINMETZ X	1D LAZARUS - 1
46G	TAPPAN X	2D LAZARUS - 2
46H	WHITMAN X	3D LAZARUS - 3
47A	ANTHONY X	4D LAZARUS - 4
47B	COOPER X	5D LAZARUS - 5
48C	FULTON X	6D LAZARUS - 6
48D	IRVING X	7D LAZARUS - 7
49	EASTMAN TOWER X	
		801 A1 LIBERTY LN
		802 A2 LIBERTY LN
		803 A3 LIBERTY LN
		801 B1 LIBERTY LN
		802 B2 LIBERTY LN
		803 B3 LIBERTY LN
		804 B4 LIBERTY LN
		805 B5 LIBERTY LN
		801 C1 LIBERTY LN
		802 C2 LIBERTY LN
		803 C3 LIBERTY LN
		804 C4 EXCELSIOR DR
		805 C5 EXCELSIOR DR
		801 D1 CAPITAL HILL
		802 D2 CAPITAL HILL
		803 D3 CAPITAL HILL
		801 E1 CAPITAL HILL
		802 E2 CAPITAL HILL
		803 E3 CAPITAL HILL
		801 F1 EXCELSIOR DR
		802 F2 EXCELSIOR DR
		803 F3 EXCELSIOR DR
		801 G1 EXCELSIOR DR
		802 G2 EXCELSIOR DR
		803 G3 EXCELSIOR DR



■ ACADEMIC BUILDINGS
■ RESIDENTIAL BUILDINGS

FALL 2015



Rehab Exterior Envelope, Downtown, Various Buildings
(\$5.6 Million)



Renovate Business Administration Building
(\$43.9 Million)



Renovate Lecture Center
(\$27.6 Million)

University at Albany

State University of New York 2016/2017 Capital Program Plan (In Thousands)
Major Ongoing Non-Hospital Projects (Over \$1M Construction Cost)

State University of New York at Albany

PROJECTS UNDER DESIGN

Capital Plan Projects	Total Estimated Project Cost	YTD Expend. thru 07-31-16	LTD Expend. thru 07-31-16	Encumbered Amount 07-31-16	Anticipated Start of Construction				
					16/17	17/18	18/19	19/20	20/21
Renovate Sub-Basement Lecture Center South	\$4,749	\$68	\$68	\$476		X			
Upgrade Central Plant Lecture	\$12,210	\$175	\$175	\$1,739		X			
Rehab Toilet Rooms for ADA - Podium	\$9,966	\$0	\$0	\$1,016		X			
Replace Roofs - Downtown Various Buildings	\$4,420	\$0	\$0	\$467		X			
Renovate Building 27 For Education	\$43,932	\$332	\$427	\$3,554		X			
Sanitary & Storm Improvements - Alumni Quad	\$1,210	\$0	\$0	\$119	X				
Renovate Podium for Surge - Phase I	\$4,209	\$67	\$109	\$64	X				
Construct ETEC Building - 2020	\$180,084	\$0	\$6,700	\$6,700			X		
Renovate Lecture Center	\$27,647	\$158	\$158	\$2,234		X			
Renovate Former Albany High School - Phase II	\$59,058	\$221	\$221	\$4,524		X			
Design Totals:	\$347,484	\$1,021	\$7,858	\$20,893					

PROJECTS UNDER CONSTRUCTION

Capital Plan Projects	Total Estimated Project Cost	YTD Expend. thru 07-31-16	LTD Expend. thru 07-31-16	Encumbered Amount 07-31-16	Anticipated Completion Date				
					16/17	17/18	18/19	19/20	20/21
Implement Lghting Master Plan, Phase I	\$2,650	\$1,135	\$2,121	\$410	X				
Renovate Health Center	\$14,578	\$3,729	\$4,728	\$7,812		X			
Construct Campus Center Expansion	\$58,618	\$18,036	\$41,402	\$11,283	X				
Elevator Renovations, Various Buildings -Phase III	\$2,755	\$35	\$295	\$2,209		X			
Rehab Exterior Envelope, Downtown - Various Buildings	\$5,576	\$1,634	\$1,970	\$2,843	X				
Fire Alarm Upgrades Downtown Campus	\$2,379	\$1,350	\$1,868	\$404	X				
Renovate Classrooms/Labs Phase IV	\$1,617	\$324	\$1,582	\$0	X				
Podium Concrete Deck Rehab-Phase II	\$5,500	\$1,388	\$3,258	\$192	X				
Construct ETEC Building - 2020 - Electrical Ductbank	\$6,898	\$0	\$0	\$0		X			
Replace Exterior Doors Uptown - Phase 1	\$2,824	\$65	\$158	\$237		X			
Construction Totals:	\$103,395	\$27,697	\$57,383	\$25,392					

State University of New York 2016/2017 Capital Program Plan (In Thousands)
 Future Planned Projects - Over \$1M Construction (Non-Hospital)

State University of New York at Albany

Capital Plan Projects	Total Estimated Project Cost	Funds Available	Funds Needed to Complete	SFY 2016/2017 Phase \$	SFY 2017/2018 Phase \$	SFY 2018/2019 Phase \$	SFY 2019/2020 Phase \$	SFY 2020/2021 Phase \$
Rehab Masonry Quad Areas	\$3,000	\$0	\$3,000	D \$400		C \$2,600		
Upgrade Podium Unitary Cooling Equipment	\$9,515	\$0	\$9,515	D \$1,240		C \$8,275		
Renovate Campus Center ph 3	\$29,000	\$0	\$29,000		D \$4,000		C \$20,000	
Renovate Physical Education Building Phase 1	\$20,113	\$0	\$20,113		D \$8,880		C \$10,000	
Upgrade OGS Electrical Substation	\$7,000	\$0	\$7,000		C \$7,000			
Rehab Library for Surge Space	\$9,488	\$0	\$9,488		D \$1,209	C \$8,086		
							E \$193	
Capital Plan Project Totals:	\$78,116	\$0	\$78,116	\$1,640	\$21,089	\$18,961	\$30,193	\$0

Project Phases: A = Acquisition, D = Design, C = Construction, E = Equipment

State University of New York Summary of Changes Capital Program Plan (In Thousands)
Non-Hospital Project Cross-Reference: Current Year Status vs. Last Year

State University of New York at Albany

Capital Plan Project	2015 Estimated Project Cost	2016 Estimated Project Cost	Incr.Decr. In Estimate Cost
Projects Under Design			
Upgrade Central Plant	\$15,452	\$12,210	(\$3,242)
Rehab Toilet Rooms for ADA - Podium	\$7,275	\$9,966	\$2,691
Renovate Podium for Surge - Phase I	\$6,516	\$4,209	(\$2,307)
Construct ETEC Building - 2020	\$180,084	\$180,084	\$0
Renovate Lecture Center	\$27,648	\$27,647	(\$1)
Renovate Former Albany High School - Phase II	\$59,058	\$59,160	\$102
Phase Total:	\$296,033	\$293,276	(\$2,757)
Projects Under Construction			
Renovate Health Center	\$13,291	\$14,578	\$1,287
Renovate University Library, Phase 1	\$1,942	\$2,134	\$192
Elevator Renovations, Various Buildings - Phase III	\$1,730	\$2,755	\$1,025
Rehab Exterior Envelope, Downtown - Various Buildings	\$4,862	\$5,576	\$714
Renovate Classrooms/Labs Phase IV	\$1,352	\$1,617	\$265
Renovate Former Albany High School - Phase I	\$3,100	\$3,120	\$20
Podium Concrete Deck Rehab - Phase II	\$3,020	\$5,500	\$2,480
Construct ETEC Building - 2020 Ductbank	\$2,500	\$6,898	(\$4,398)
Replace Exterior Doors Uptown - Phase 1	\$3,004	\$2,824	(\$180)
Phase Total:	\$34,801	\$45,002	\$1,405
Completed Projects			
Relocate University Data Center	\$31,472	\$31,493	\$21
Rehabilitate Water Tower and Fountains	\$21,040	\$21,831	\$791
Phase Total:	\$52,512	\$53,324	\$812